

T LINE NOZZLE



The T Line of rotary nozzles provides advanced solutions for efficient cleaning of heat exchangers, evaporators, pre-evaporators, and pipelines in general. Assisted by a jet propulsion system, there are two inserts positioned at a 5° angle on the radial surface, promoting rotary movement of the nozzle during the cleaning process. The T1000 model is available for both

available in BSP thread.

PIPE DIAMETER

T1400: De Ø21 mm até Ø68 mm
T1000: De Ø31 mm até Ø36 mm

Ø INSERTS (M4 AND M3 STAINLESS STEEL OR CERAMIC)

The choice of the insert is based on the equipment's flow rate and the type of encrustation to be removed.

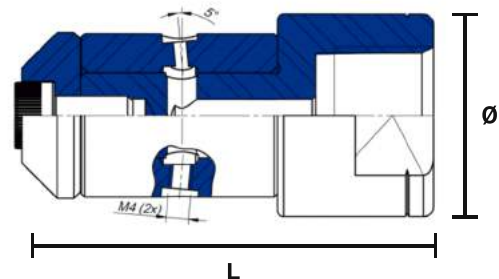

T 55 F 10 2 O

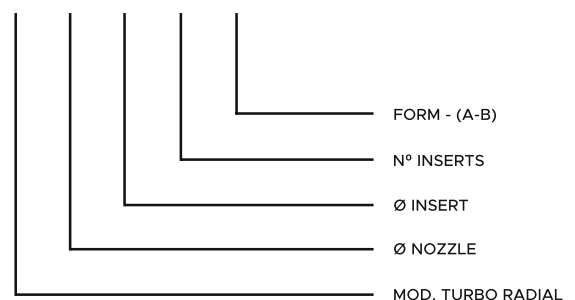

T LINE (T1000 & T1400)

TECHNICAL DATA T1000:

| MODEL | WIDTH | THREAD | INSERT THREAD | 0.7 | 0.8 | 0.9 | 1.0 | 1.2 |
|-------|--------------------|---------------------|---------------|-----|-----|-----|-----|-----|
| T 28 | 65 mm (2.55 in) | 1/2" (BSP e NPT) | M4 | - | ✓ | ✓ | ✓ | - |
| T 31 | 65 mm (2.55 in) | 1/2" (BSP e NPT) | M4 | - | ✓ | ✓ | ✓ | - |
| T 33 | 65 mm (2.55 in) | 1/2" (BSP e NPT) | M4 | - | ✓ | ✓ | ✓ | - |

TECHNICAL DATA T1400:

| MODEL | WIDTH | THREAD | INSERT THREAD | 0.7 | 0.8 | 0.9 | 1.0 | 1.2 |
|-------|--------------------|---------------|---------------|-----|------|------|-----|-----|
| T 10 | 35 mm (1.37 in) | M7 (BSP) | - | - | (DB) | (DB) | - | - |
| T 12 | 39 mm (1.53 in) | 1/8" (BSP) | - | - | (DB) | (DB) | - | - |
| T 15* | 41 mm (1.61 in) | 1/8" (BSP) | - | - | (DB) | (DB) | - | - |
| T 18 | 46 mm (1.81 in) | 1/4" (BSP) | M3 | - | (DB) | (DB) | - | - |
| T 22 | 57 mm (2.24 in) | 1/4" (BSP) | M3 | ✓ | ✓ | ✓ | ✓ | ✓ |
| T 28 | 65 mm (2.55 in) | 1/2" (BSP) | M4 | ✓ | ✓ | ✓ | ✓ | ✓ |
| T 31 | 65 mm (2.55 in) | 1/2" (BSP) | M4 | ✓ | ✓ | ✓ | ✓ | ✓ |
| T 33 | 69 mm (2.71 in) | 1/2" (BSP) | M4 | ✓ | ✓ | ✓ | ✓ | ✓ |
| T 35 | 69 mm (2.71 in) | 1/2" (BSP) | M4 | ✓ | ✓ | ✓ | ✓ | ✓ |
| T 45 | 73 mm (2.87 in) | 1/2" (BSP) | M4 | ✓ | ✓ | ✓ | ✓ | ✓ |
| T 55 | 88 mm (3.46 in) | 1/2" (BSP) | M4 | ✓ | ✓ | ✓ | ✓ | ✓ |
| T 75 | 95 mm (3.74 in) | 1/2" (BSP) | M4 | ✓ | ✓ | ✓ | ✓ | ✓ |

(DB): Drilled in the bushing.



IN-HOUSE MANUFACTURING

Comet do Brasil Indústria e Comércio de Equipamentos LTDA.



LEARN MORE ABOUT OUR PRODUCT

lemasa-usa.com



lemasa-usa.com

